

THE COFFEE WORKSHOP

1kg Electric Coffee Roaster

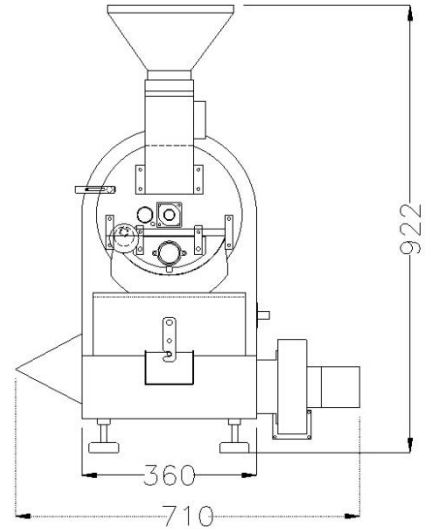

Specifications

- Heating Elements: 5 x 700 watts (total 3500 watts)
- Batch capacity: 200gm - 1kg (max 1.2kg green weight))
- Roasting time: 1kg = 14 -18mins, capacity per hour: 3-4 kgs.
- Dimensions: D800mm x W710mm x H922mm
- Gross weight: 150 kgs (includes shipping crate), 100kgs net of crate.
- Crate cubic measurement: 1.2 cubic metres.
- Voltage: 220v/ 50-60hz
- Power requirements: 20 amps.
- Normal operating temperature range: 160- 220 degrees C (max: 300 degrees)
- Motors x 4
 - Main motor: 90w
 - Smoke extractor motor: 50w
 - Cooling motor: 50w (graduated control means precise control)
 - Stirring motor: 15w
- Body: High temp stainless steel
- Drum: High temp stainless steel, thickness 4mm, diameter 230mm
- Cooling tray: 315mm, cooling wing length: 130mm.
- Chaff collector/ cyclone dimensions: 780mm x 340mm x 45mm.
- Temperature controller: Fotek PID + Fuzzy Logic controller

Features:

- Back to back roasting
- Built in timer with alarm
- Temperature preset with alarm
- Electronic temperature and timer display
- Additional heat control through cooler adjustment
- Efficient cooling tray: 1-2 minutes cooling time.
- Electric ignition
- PID Fuzzy Logic temperature controller for precise temperature control during roast
- Certifications: CE 2006/95/EC, CE 2006/95/EC, RoHs 2011/65/EU

Optional Extras:

- Extra temperature Probe
- ET Probe and temp gauge
- Data logger/Variable speed drum